



Thank you for your interest in Covenant Christian School. CCS exists to support Christian parents in their task of raising children of faith.

Please take some time to read through the documents included in this package as they will give you more information about the school and the enrolment process. If you have any question about the documents or the procedure, please contact the school office at (780) 986-8353.

We have some specific forms and processes involved in the enrolment procedure, as outlined below. In order to begin the enrolment process, there are several documents that we ask you to complete and submit:

- Black Gold Regional Schools enrolment form(s) – 1 per child in Kindergarten to grade 9 (Please fill these out online at ccs.blackgold.ca)
- Copies of most recent report cards for all children currently in K-8 (may be uploaded with online registration)
- Copy of Birth Certificate(s) (may be uploaded with online registration)
- Application for Enrolment Form*
- Financial Arrangement & Transportation Application Form*
- Membership Form*
- Partnership Agreement* - signed by parent(s) and student(s)
- \$50 Registration Fee*
- Void cheque – if selecting “automatic withdrawal” for fee payment*

In addition, please provide your pastor with the “Confidential Pastor’s Report” and have them return it to the school via mail, email or fax (see address/number below). **Your application will not be processed until this letter has been received.**

After we receive the above mentioned documents, as well as the pastoral reference, you will be contacted for an in-person interview. **A decision on enrolment acceptance will be made following this meeting.**

Completed application packages can be dropped off at the school or mailed to:

Covenant Christian School

Box 3827

Leduc, AB T9E 6M7

Fax: (780) 986-8360

Email: cheri.andres@blackgold.ca



Application for Enrolment

Family Information:

Parent/Guardian Name(s): _____

Church Affiliation: _____ *Not attending church*

Pastor's Name: _____

Student Information:

| Child's Name | Grade in 2017-2018 | Currently or previously on an Individual Program Plan (IPP)? <small>* If "YES", please attach a copy of most recent IPP</small> | Had academic and/or psychological testing? <small>* If "YES", please attach a copy of most recent assessment</small> |
|--------------|--------------------|--|---|
| | | <input type="checkbox"/> Yes <input type="checkbox"/> No | <input type="checkbox"/> Yes <input type="checkbox"/> No |
| | | <input type="checkbox"/> Yes <input type="checkbox"/> No | <input type="checkbox"/> Yes <input type="checkbox"/> No |
| | | <input type="checkbox"/> Yes <input type="checkbox"/> No | <input type="checkbox"/> Yes <input type="checkbox"/> No |
| | | <input type="checkbox"/> Yes <input type="checkbox"/> No | <input type="checkbox"/> Yes <input type="checkbox"/> No |
| | | <input type="checkbox"/> Yes <input type="checkbox"/> No | <input type="checkbox"/> Yes <input type="checkbox"/> No |

Questionnaire - Please provide answers to the following questions:

1. How did you come to know about Covenant Christian School (CCS)?

2. Why do you wish to enroll your child(ren) at CCS?

Parent Commitment:

By submitting this form, I/we certify that:

- I/we understand and agree with the *CCS Education Vision Document* and the *Partnership Agreement* and wish to enroll my/our child(ren) in an educational program in accordance with this document;
- I/we agree, as a condition of enrolment and continued enrolment, to pay the total fees as indicated above and in the manner indicated above. I/we also acknowledge that there may be a change in program and transportation fees prior to September 1st and that the Society will notify me/us of fee changes;
- As part of the the Freedom of Information and Protection of Privacy Act (FOIPP), I/we understand that the personal information collected on this form is part of LSCE's enrolment process and is used to provide an educational program and ensure a safe and secure school environment.

Signature of First Parent/Guardian: _____ Date: _____

Signature of Second Parent/Guardian (optional): _____ Date: _____

I/we agree to give the Leduc Society for Christian Education (LSCE) permission to access information on the Black Gold Student Registration Form, Application for Enrolment Form, and Transportation & Financial Commitment Form Yes No

I/we give permission to publish our names, addresses and phone numbers in the school's annual directory Yes No

I/we give permission for publication of my/our child(ren)'s work and/or photographs of my/our child(ren) taken during public LSCE or school events in LSCE or school publications. Yes No

Financial Arrangement & Transportation Application

Family Information:

Parent/Guardian Name(s):

Mailing Address:

Mailing Street

City

Prov.

Postal Code

Phone:

County Rural Address (ex. 50068 Range Road 214):

(Legal Land Description if County Rural Address is unavailable)

* Alternate Parent/Guardian Name(s):

* Mailing Address:

Mailing Street

City

Prov.

Postal Code

* Phone:

County Rural Address (ex. 50068 Range Road 214):

(Legal Land Description if County Rural Address is unavailable)

Student Information: (NOTE: Please include child(ren) registered for Preschool)

| Child's Name | Gender | Grade in 2017-2018 |
|--------------|---|--------------------|
| | <input type="checkbox"/> Male <input type="checkbox"/> Female | |
| | <input type="checkbox"/> Male <input type="checkbox"/> Female | |
| | <input type="checkbox"/> Male <input type="checkbox"/> Female | |
| | <input type="checkbox"/> Male <input type="checkbox"/> Female | |
| | <input type="checkbox"/> Male <input type="checkbox"/> Female | |

Transportation Requirements: (see the attached Covenant Christian School TRANSPORTATION sheet for more information)

County **outside** of City of Leduc Catchment Area-Covenant Bus (if yes then fill out box below)

Do not require bussing

Please register with Black Gold Regional Schools if you live in the county and are within the City of Leduc catchment area or within the City of Leduc. See boundary map on reverse. Contact Sue Timmermans at (780) 955-6034 or sue.timmermans@blackgold.ca.

Special Arrangements/Dual Route Ridership (please attach a note with schedule request if your children will not ride the bus in both am and pm consistently)

AM Pick-Up Address (if different from home address):

PM Drop-Off Address (if different from home address):

I/we give permission for the LSCE to share my contact/emergency contact information with the designated bus route phone volunteer for the purposes of establishing contact in the event of an emergency Yes No

Attachment " " BERSD BUSSING BOUNDARY

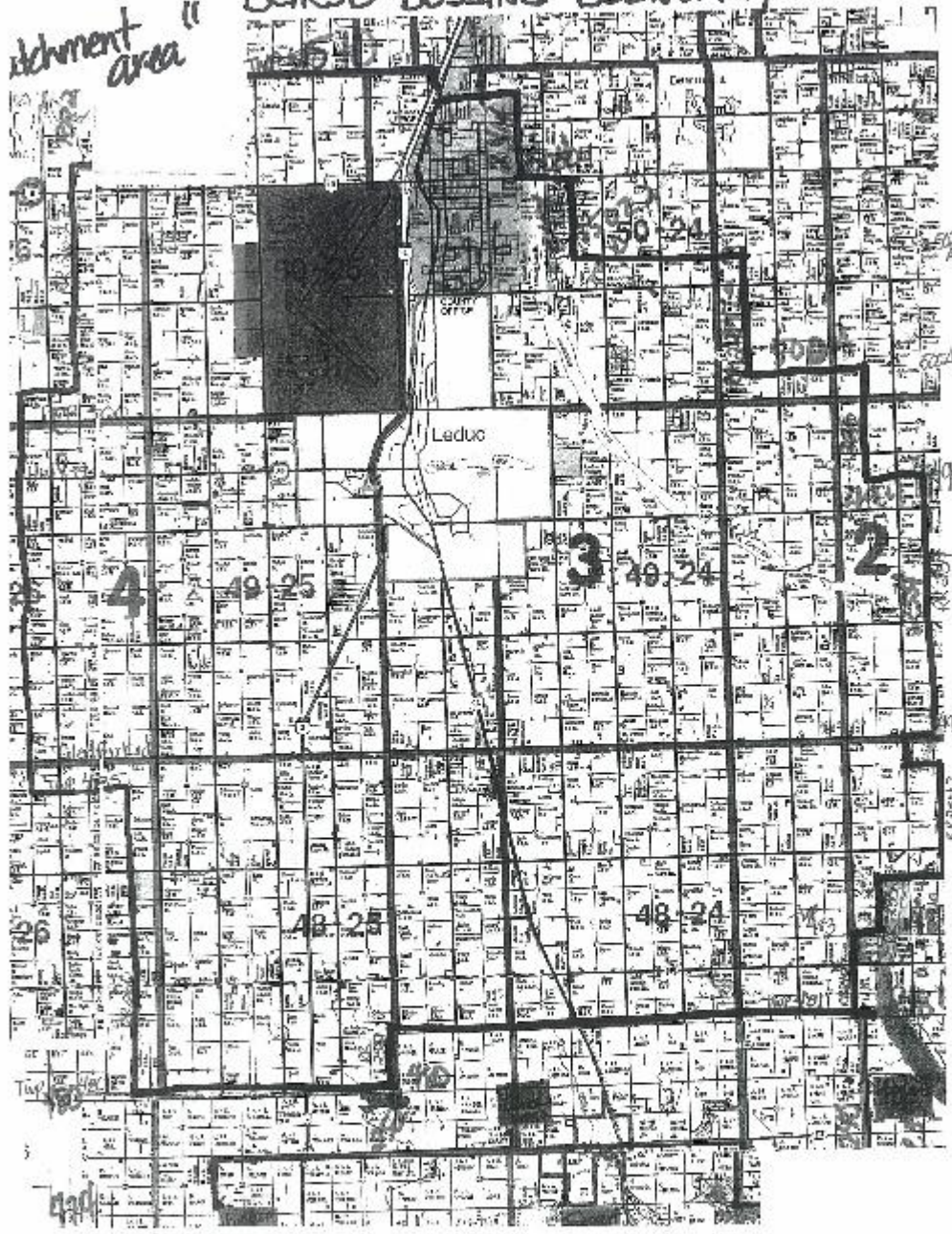

1) **Registration Fee:** A \$50 registration fee (cheques payable to “The Leduc Society for Christian Education” and post-dated to June 27th) must be attached to this application form. If enrolment is approved, this fee will be deducted from the total fees payable. If enrolment is not approved, the fee will be refunded. However, if enrolment is cancelled after it is approved; the fee will not be refunded.

2) **Payment Schedule:**

- Payment in full by September 30th (\$75 discount will be applied to the official invoice issued in September)
- Monthly payments (payments will be divided over ten months starting in September)
- Other (please describe; for example: “two payments per month”):

3) **Method of Payment:**

- Post-dated cheques – **must be dated for the 1st, 15th or 20th** of each month, and submitted to the Society office by September 15th
- Monthly Automatic Bank Withdrawal (attach voided cheque) **or** Authorization Form Completed
- Preferred withdrawal: 10th or 25th of the month

4) **Application for Bursary:** (Note: A payment schedule and method of payment must still be selected above)

- Reduced Fees:
- A limited fund is available for those families who can demonstrate their inability to pay full fees.
 - Application form is to be completed and is subject to approval.
- Pastor’s Bursary:
- Must be a pastor working in a recognized Christian church.
 - Pastoral work must represent at least one-half of the pastor’s overall work time as well as 50% of the family income.
 - Contact the Society Administrator to obtain an application – subject to approval.

The Leduc Society for Christian Education (LSCE) will issue a preliminary invoice by June 30th based on the approved fee guide and your selections. Official invoices will be issued in mid-September.

Acknowledgement

By submitting this form, I/we certify that:

- it is accurate and complete;
- I/we understand that this information is being collected to provide transportation services and grant eligibility under the School Act. Video cameras may be used on school busses for safety and discipline purposes only;
- I/we agree to comply with all of the LSCE’s requirements for transportation services, as outlined in the attached Transportation Guidelines, School Bus Safety Rules and Fee Schedule, and understand that failure to comply may result in loss of busing privileges;
- I/we agree, as a condition of enrolment and continued enrolment, to pay the total fees as indicated in the fee guide and in the manner indicated above. I we/also acknowledge that there may be a change in program and transportation fees prior to September 1st and that the Society will notify me/us of fee changes.

Signature of Parent/Guardian: _____

Date: _____

Leduc Society for Christian Education

Covenant Christian School
Box 3827 Leduc, AB T9E 6M7
Phone: 780-986-8353 Fax: 780-986-8360
ccs.blackgold.ca



Covenant Christian School is an “Alternative Program” within the Black Gold School Division. The Leduc Society for Christian Education (LSCE) provides the building and land and as such is responsible for capital upgrades and maintenance. The LSCE also oversees Christian programming, a transportation system, and a preschool program.

The enclosed “Education Vision Document” is a foundational document for Covenant Christian School/LSCE as it describes the Christian principles on which our school is based. To achieve our purpose as explained in this document, we require all families at CCS to share this vision, become members of the LSCE, and intentionally teach the beliefs and values described in this document in their homes. The Constitution and Bylaws which govern our vision are found on our website (ccs.blackgold.ca).

Please fill out the information below for all those who would like to become members of the Leduc Society for Christian Education. At least one parent/guardian of each student must be a member, but we encourage all parents or guardians to join. There is a \$25 annual fee per membership.

Application for Membership in The Leduc Society for Christian Education

I have read and embrace the vision and mission of Covenant Christian School as expressed in “The Education Vision” document.

I have read and support “The Leduc Society for Christian Education Constitution” and “The Leduc Society for Christian Education Bylaws”.

Child(ren) attending Covenant: _____

| Member’s Name | Address | Signature | Date |
|---------------|---------|-----------|------|
| | | | |
| | | | |
| | | | |
| | | | |

Covenant Christian School Partnership Agreement

Family Name: _____

Parents/Guardians

We will:

- Be committed to the vision, mission, values and program of the school
- Support the school through prayer, encouragement, involvement and attendance at school and Society functions
- Model a Christ-like attitude in communication and interaction with school personnel and other parents
- Ensure our children participate fully and respectfully in the school's integrated Christian program, which includes devotions, Bible study and service.
- Support and reinforce with our children the school's expectations.
- Set appropriate expectations for our children and ensure they establish positive home study routines
- Support and encourage communication between parents, teachers and students, and review and sign report cards, permission slips and other documents as needed
- Provide a home environment that supports the Christian school program
- Ensure our children are at school on time

Students

I will strive to:

- Be committed to the vision, mission, values and program of the school
- Participate respectfully and fully in the school's integrated Christian program, which includes devotions, Bible study and service
- Respect my fellow students, school personnel, school property and myself by making choices that reflect a Christ-like attitude
- Pray for other students at the school
- Work hard, try the best I can to succeed and learn, and strive to develop the talents and gifts God has given me in preparation for life-long service to the Lord
- Abide by the school rules:
 - I am responsible for my learning
 - I respect people
 - I follow directions the first time
 - I cooperate and play fair
 - I respect property

Parent/Guardian

Parent/Guardian

Student

Student

Student

Student

Covenant Christian School

Education Vision Document

A. Core Purpose

- Flourishing Learners
- Delighting in God
- Inspired to Serve

B. Biblical Foundations

As followers of Jesus Christ, living in this world, we declare with joy and trust: Our world belongs to God! This includes the world of education and on that basis we affirm the following principles related to our Christian faith and the role of education.

Creation: we affirm that in the beginning God - Father, Son and Spirit - called this world into being out of nothing and gave it shape and order. God continues to direct all that happens in His world.

Sin: we affirm that people's disobedience to God has broken the relationship between God and us. Looking for life without God, we find only death, leaving us blind to our place in the world and to the meaning of life.

Redemption: we affirm that Jesus Christ, the eternal Word made flesh, conquered sin and death. Being both God and man, Jesus is the only mediator between God and His people. He alone paid the debt of sin; there is no other Saviour. It is through Christ that all areas of life, including education, are redeemed and restored. Therefore, it is only in Christ that we are able to discover the meaning and purpose of life.

Our Purpose: we affirm that the rule of Jesus Christ covers the whole world. To follow the Lord is to serve Him everywhere, including the field of education.

Scriptures: we affirm that the Bible is the Word of God. It is the Word of Truth, fully reliable in leading us to know God and have life in Jesus Christ. It infallibly tells of God's mighty acts, reveals His will and His plan of salvation.

Students: we affirm that students, of whatever ability, are to be treated as people who bear God's image and have a place in His plan. We strive to guide students into a deeper understanding of God's world so that they can take up their calling as faithful stewards of their God-given tasks, both now and in the future.

Parents: we affirm that the responsibility for the education of children rests primarily with the parents, to whom children are entrusted by God.

Teachers: we affirm that parents entrust Christian teachers with the responsibility of instructing students. Teachers, in co-operation with the parents, are responsible for integrating a Christian perspective in all aspects of schooling, including the curriculum, and also for living a godly life, as described in the Bible.

School: we affirm that a primary task of the Christian school is guiding students into a deeper understanding of God's creation and its history. Christian schools help nurture children in the Biblical faith so they can take up their calling as faithful stewards of their God-given tasks.

The Christian Community: we affirm that since Christian education plays an important role in the growth of the Kingdom of God, the wider Christian community, not only parents of students, has a responsibility to nurture children and play an active role in their education.

Knowledge: we affirm that true knowledge of God, of ourselves and of all of creation, is made possible only by a true faith in Jesus Christ, and finds its source in the Word of God, through the direction of the Holy Spirit.

(Some parts of the above section are based on "Our World Belongs to God", a document of the Christian Reformed Church)



Covenant Christian School

Confidential Pastor's Report

Family Name: _____

| | | | |
|--|--|--|-----------------------------|
| Father | | | |
| How long have you known him? | Describe regularity of church attendance | Actively involved in church ministries? | Accepted Christ as Saviour? |
| What responsibilities does he have in the church? | | | |
| Mother | | | |
| How long have you known her? | Describe regularity of church attendance | Actively involved in church ministries? | Accepted Christ as Saviour? |
| What responsibilities does she have in the church? | | | |
| Children | | | |
| Do the children attend church regularly? | | Are the children actively involved in children/youth ministry? | |
| Family | | | |
| Is this family supportive of your ministries and work of the church? | | | |
| Do you feel this family would be supportive of a Christ-centred school? | | | |
| Comments | | | |
| <hr/> <hr/> <hr/> <hr/> <hr/> | | | |
| Teachings Agreement | | | |
| I have read the "Biblical Foundations" document on the reverse and find that it agrees with the teachings of our church. | | | |
| Pastor's Name | Pastor's Signature | Date | |
| Church Name | Church Phone | | |

Please fax/mail the completed form.
780-986-8360(fax)
Covenant Christian School
Box 3827
Leduc, AB T9E 6M7
Covenant Christian School: Biblical Foundations

As followers of Jesus Christ, living in this world, we declare with joy and trust: Our world belongs to God! This includes the world of education and on that basis we affirm the following principles related to our Christian faith and the role of education.

Creation: we affirm that in the beginning God - Father, Son and Spirit - called this world into being out of nothing and gave it shape and order. God continues to direct all that happens in His world.

Sin: we affirm that people's disobedience to God has broken the relationship between God and us. Looking for life without God, we find only death, leaving us blind to our place in the world and to the meaning of life.

Redemption: we affirm that Jesus Christ, the eternal Word made flesh, conquered sin and death. Being both God and man, Jesus is the only mediator between God and His people. He alone paid the debt of sin; there is no other Saviour. It is through Christ that all areas of life, including education, are redeemed and restored. Therefore, it is only in Christ that we are able to discover the meaning and purpose of life.

Our Purpose: we affirm that the rule of Jesus Christ covers the whole world. To follow the Lord is to serve Him everywhere, including the field of education.

Scriptures: we affirm that the Bible is the Word of God. It is the Word of Truth, fully reliable in leading us to know God and have life in Jesus Christ. It infallibly tells of God's mighty acts, reveals His will and His plan of salvation.

Students: we affirm that students, of whatever ability, are to be treated as people who bear God's image and have a place in His plan. We strive to guide students into a deeper understanding of God's world so that they can take up their calling as faithful stewards of their God-given tasks, both now and in the future.

Parents: we affirm that the responsibility for the education of children rests primarily with the parents, to whom children are entrusted by God.

Teachers: we affirm that parents entrust Christian teachers with the responsibility of instructing students. Teachers, in co-operation with the parents, are responsible for integrating a Christian perspective in all aspects of schooling, including the curriculum, and also for living a godly life, as described in the Bible.

School: we affirm that a primary task of the Christian school is guiding students into a deeper understanding of God's creation and its history. Christian schools help nurture children in the Biblical faith so they can take up their calling as faithful stewards of their God-given tasks.

The Christian Community: we affirm that since Christian education plays an important role in the growth of the Kingdom of God, the wider Christian community, not only parents of students, has a responsibility to nurture children and play an active role in their education.

Knowledge: we affirm that true knowledge of God, of ourselves and of all of creation, is made possible only by a true faith in Jesus Christ, and finds its source in the Word of God, through the direction of the Holy Spirit.

(Some parts of the above are based on "Our World Belongs to God", a document of the Christian Reformed Church)



Leduc Society for Christian Education

Covenant Christian School
 Box 3827 Leduc, AB T9E 6M7
 Phone: 780-986-8353 Fax: 780-986-8360
 ccs.blackgold.ca

Covenant Christian School Fees List for 2017 – 2018

| Mandatory Fees: | |
|--|---------------------------|
| Society Membership | \$25 / parent or guardian |
| Recreation/Transportation Support fee (for all families except Preschool only families) | \$325 / family |
| Recreation/Transportation Support fee – Kindergarten student only | \$160 / family |

| Education Fees: | |
|---|-------------------------|
| Preschool | \$750 + \$50 supply fee |
| Kindergarten | \$700 |
| One Child in grades 1-9 | \$1,600 |
| Second Child in grades 1-9 | \$1050 (\$2,650 total) |
| Third Child in grades 1-9 | \$500 (\$3,150 total) |
| <p>*** <i>There are no additional education fees for K-9 if you have more than three children in the school; however, Preschool fees always apply.</i></p> | |

| Bussing Fees: | |
|---|---|
| Rural Covenant Bus (Rural riders outside City of Leduc catchment area) | \$1,850 / family (\$925 for kindergarten rider only) |
| Rural riders not attending CCS | \$2,050 / family |
| High-school rider (CCS family) | \$225 |
| <p>*** Please note: Part-time ridership is available on a case by case basis and must be approved by the Transportation Committee.</p> | |



Covenant Christian School **TRANSPORTATION** **780-986-8353**

Covenant Christian is a school of choice. Black Gold Regional Schools will provide busing to our school provided you are within their designated boundary and for the school of choice fee. Read below for details. If you have questions about busing or are unsure of which busing region you live in, please contact the CCS Transportation Coordinator.

1. **City of Leduc & County of Leduc within Black Gold Regional School (BGRS) boundary:** If you live within BGRS boundary, BGRS will bus your students from your home bus stop to the Transfer Point at Leduc Junior High School (LJHS). Then from the transfer to Covenant Christian School.
 - a. Register/pay at BGRS Transportation (780-955-6048) or @ www.blackgold.ca

2. **Outside of BGRS bussing boundary:** Covenant Christian School offers busing in limited areas within the County of Leduc, including Rollyview, Beaumont, Cloverlawn Hall, Millet, and Calmar etc. It is possible that you will drive to a pick up location to meet the CCS bus as door-to-door service is not guaranteed. We currently have 2 buses that are servicing these areas. Route time is approximately 90 min from start to finish. Contact Cindy Feldbusch @ 780-986-8353 or by email at cindy.feldbusch@blackgold.ca.

Other Information:

1. If the oldest child is in Kindergarten, CCS kindergarten bussing is pro-rated to half of the fee required for bussing.
2. Payment for bussing is handled through Leduc Society for Christian Education along with your registration to Covenant Christian School.

*Please see attached document for bussing fees.